

PROFESSIONAL OFFICE/INDUSTRIAL UNIT FOR LEASE

260-284 Quarry Road, Unit N, Milford, CT



To arrange a tour contact:
Scott Zakos 203-226-7101 Ext 4
scott@vidalwettenstein.com



VIDAL/WETTENSTEIN, LLC



719 Post Road East, Westport, CT 06880
www.vidalwettenstein.com

All information from sources deemed reliable and is submitted subject to errors, omissions, change of price, rental, and property sale and withdrawal notice.

260-284 Quarry Road, Milford, CT



SPACE DETAILS

Area: 7,094± SF

Ceiling Height: 14' – 16'

Zoning: ID

Parking: In Common

AC: Yes 100%

Loading Docks: 3 exclusive docks

Sprinkler: Yes, wet system

Heating: Gas

Gas: Yes

Water/ Sewer: City

Lease rate: \$10.25 PSF NNN (\$4.20)



Location: Ideal location off exit 40 of I-95

260-284 Quarry Road, Milford, CT

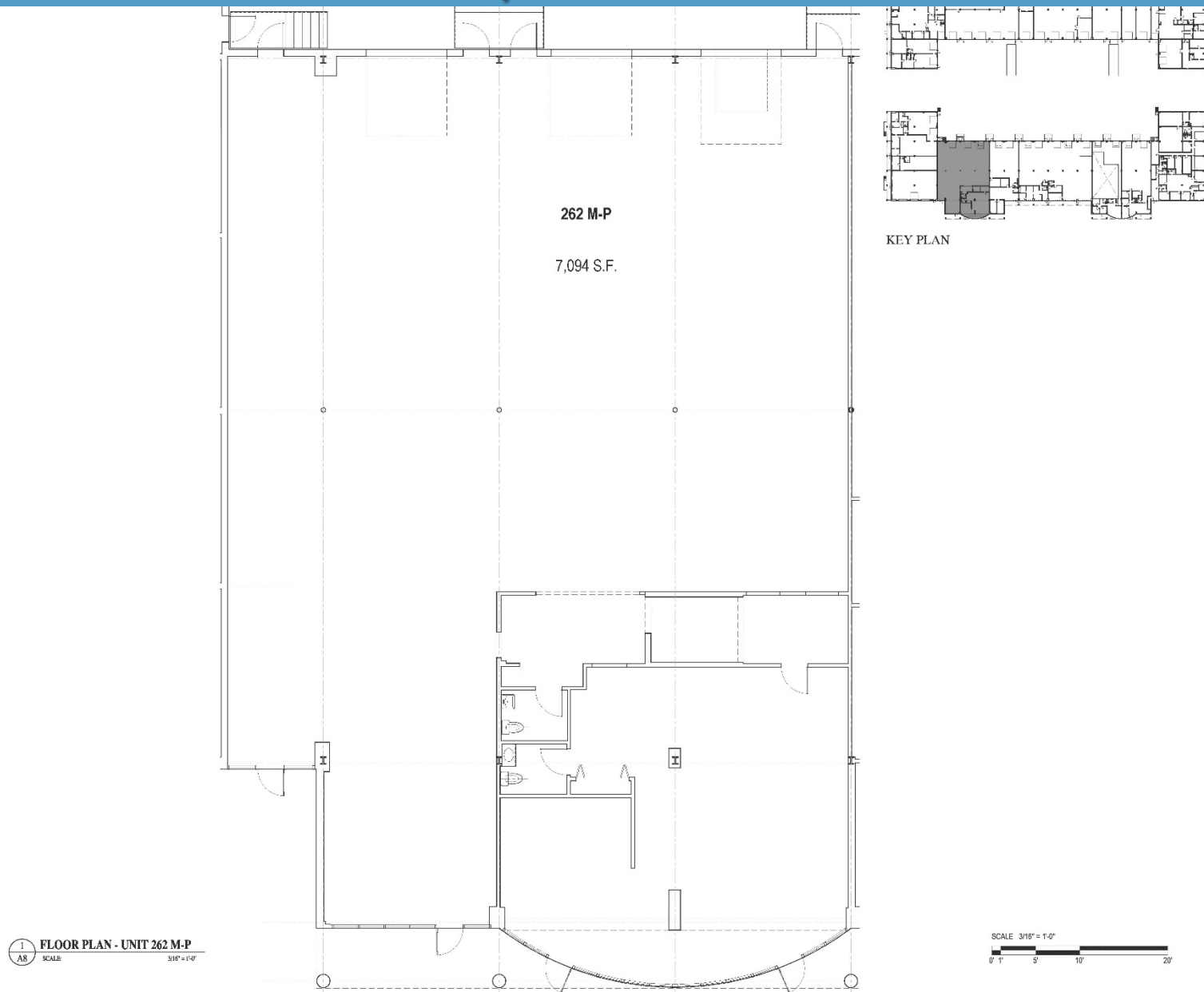

WALL TYPES LEGEND

Existing to remain
Existing to be removed
New Construction

SUBMITTED

No. DATE

All reports, plans, specifications, drawings, and other documents prepared by the Consultant shall remain the property of the Consultant. The Consultant shall retain all reserved rights, including, without limitation, the copyright therein.

262 M-P
NO. 001
DATE: 08/02
SCALE: AS SHOWN
DRAWN: JCS
CHECKED: JAW
DATE: 07/20/2017

Existing Conditions
260-284 Quarry Road, Milford, CT
Proposed for: John Libano
LX Real Estate Partners
FLOOR PLAN
JOHN A. WICKO
ARCHITECT
LLC
18 TROBROOK STREET, MILFORD, CT 06460 (203) 878-6060

A8

260-284 Quarry Road, Milford, CT

