

# 54 Broad Street, Milford Connecticut



*Join other tenants in vibrant downtown green*

Space available is in Milford's downtown historic district, walking distance to banks, shops, boutiques, restaurants and train station. Convenient to I- 95 and the Merritt Parkway Connector.

All information from sources deemed reliable and is submitted subject to errors, omissions, change of price, rental, and property sale and withdrawal notice.

## AVAILABLE FOR LEASE 1,300 Square Feet

- First floor space with multiple entries
- Onsite and street parking
- Flexible lease terms (call for details)
- Adjacent to Berkshire Hathaway
- \$21.50 PSF gross + separately metered utilities



### Contact

**Scott Zakos 203.226.7101 ext. 4**  
**Email: [scott@vidalwettenstein.com](mailto:scott@vidalwettenstein.com)**



**SIOR**

Individual Members

Society of Industrial and Office Realtors

**VIDAL/WETTENSTEIN, LLC**

719 Post Road East, Westport, CT 06880

[www.vidalwettenstein.com](http://www.vidalwettenstein.com)

# 54 Broad Street, Milford CT

## 1,300 Sq Ft Space

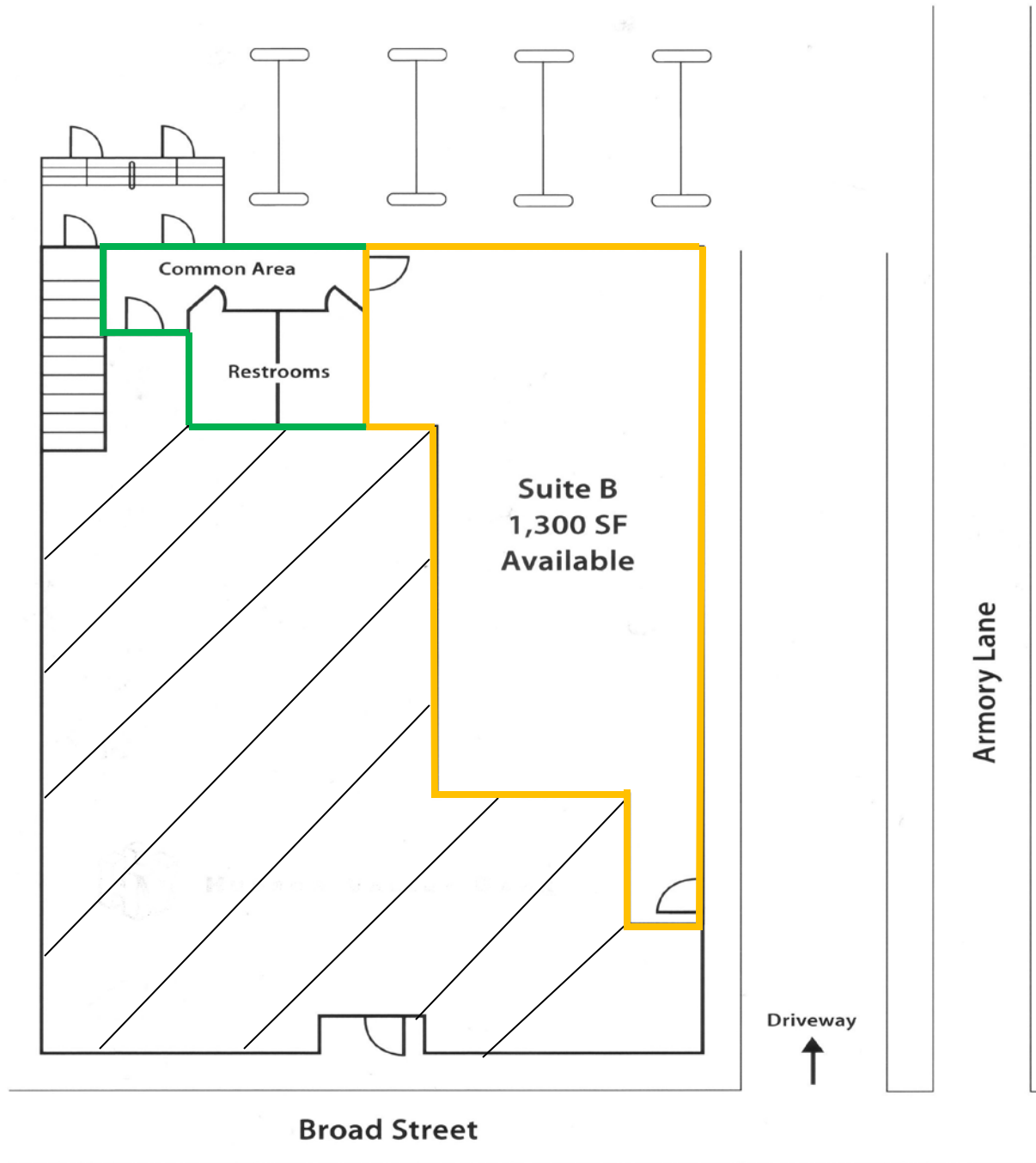

All information from sources deemed reliable and is submitted subject to errors omissions, change of price, rental, and property sale and withdrawal notice.



Individual Members  
Society of Industrial and Office Realtors

# VIDAL/WETTENSTEIN, LLC

719 Post Road East, Westport, CT 06880  
[www.vidalwettenstein.com](http://www.vidalwettenstein.com)